

Relative pressure transmitter Typ 526

Pressure range
0 ... 0.1 – 0.6 bar



The compact type 526 pressure transmitter is based upon the well proven ceramic technology developed by Huba Control over 20 years ago.

The pressure transmitter with its large variety of pressure- and electrical connection has also pressure ranges from 100 mbar full scale. These units are available in high quantities for OEM customers with an excellent price to performance ratio.

- Compact and rugged construction
- Ideal price / performance ratio
- Pressure ranges from 100 mbar full scale available
- Large selection of connections available.

Technical overview

Pressure range				
Relative	0 ... 0.1 – 0.6 bar			
Operating conditions				
Medium	Liquids and neutral gases			
		FPM	-15 ... +85 °C	
		EPDM / MVQ	-25 ... +85 °C	
		NBR	-20 ... +85 °C	
Temperature	Medium	Ambient	-25 ... +85 °C	
		Storage	-40 ... +85 °C	
Tolerable overload / Rupture pressure		3 bar		
Materials				
Plug accommodation	Polyarylamid 50% GF UL 94 V-0			
	Pressure connection	Stainless steel 1.4404 / AISI 316L		
Materials in contact with medium		PVDF		
	Sensor	Ceramic Al ₂ O ₃ (96%)		
	Sealing material	FPM, EPDM, NBR, MVQ		
Electrical overview				
3 wire	Output ratiom. 10 ... 90%	Power supply 5 VDC ± 10%	Load >10 kOhm / < 100 nF	Current consumption < 7 mA
Polarity reversal protection	Short circuit proof and protected against polarity reversal. Each connection is protected against crossover up to max. supply voltage.			
Insulation voltage	500 VDC			
Protection class				
Protection class III				
Dynamic response				
Response time	< 100 ms			
Load cycle	< 30 Hz			
Protection standard				
DIN connector EN 175301-803				IP 65
Connector M12x1				IP 67
Electrical connection				
Connector DIN EN 175301-803-A				
Connector DIN EN 175301-803-C (industrial standard 9.4 mm)				
Connector M12x1				
Pressure connection				
Inside thread	G ¼ with O-ring seal FPM (-30 ... +135 °C)			
	¼ -18 NPT			
	G ½ sealed at front			
	G ½ sealed at back DIN 3852-E with profile seal FPM (-30 ... +135 °C)			
Outside thread	G ¼ sealed at back DIN 3852-E with profile seal FPM (-30 ... +135 °C)			
	G ¼ sealed at front			
	G ½ sealed at back and manometer (combi) with profile seal FPM (-30 ... +135 °C)			
	G ½ sealed at front			
Installation arrangement				
Unrestricted				
Tests / Admissions				
Electromagnetic compatibility	CE conformity acc. EN 61326-2-3			
Weight				
~ 90 g				
Packaging (Please state on order)				
Single packaging in cardboard	accessories integrated			
Multiple packaging in cardboard (25 pcs)				

Accuracy

Parameter	Adjustment position - vertical, pressure connection downward
Characteristic line incl. thermal characteristic	± (1.8 mbar + 0.2% FS)
Resolution	0.1% FS
Long term stability acc. IEC EN 60770-1	± 0.3% FS
Positional error:	horizontal installation: ~ 0.3% FS
	vertical installation
	Pressure connection upwards: ~ 0.4% FS

			1	2	3	4	5	6	7	8	9	10	11		
Order code selection in bar			526. X X X X X X X X X X X X												
Pressure range ¹⁾	0 ... 0.1 bar		9	2	2										
	0 ... 0.16 bar		9	2	3										
	0 ... 0.2 bar		9	2	4										
	0 ... 0.25 bar		9	2	5										
	0 ... 0.3 bar		9	2	6										
	0 ... 0.4 bar		9	2	7										
	0 ... 0.6 bar		9	1	0										
Sealing material	FPM	Fluoro elastomer					0	0							
	EPDM	Ethylene propylene					1	0							
	NBR	Butadiene acrylonitrile					2	0							
	MVQ	Silicone polymer					3	0							
Output / power supply	ratiom. 10 ... 90%	5VDC ±10%						7							
Electrical connection	Connector	DIN EN 175301-803-A ²⁾								1					
		DIN EN 175301-803-C (industrial standard 9.4 mm) ²⁾								2					
		M12x1 ²⁾								3					
Pressure connection ¹⁾	inside thread	G ¼ with O-ring sealed FPM									1	1	1		
		¼ -18 NPT									3	1	1		
		G ¼ sealed at back DIN 3852-E with profile seal FPM									4	1	1		
		G ¼ sealed at front									J	1	2		
		outside thread	G ½ sealed at front									M	1	1	
			G ½ sealed at back DIN 3852-E with profile seal FPM									H	1	1	
			G ½ sealed at back and manometer with profile seal FPM									8	1	1	
			G ½ sealed at front									9	1		
Material	Stainless steel 1.4404 / AISI 316 L												1		
Pressure connection	PVDF outside thread sealed at front for G ¼, G ½												2		
Pressure range variation (optional)	Indicate W and sate range on order (e.g.: W0... + 0.5bar/OUT0.5...4.5V)													W	

			1	2	3	4	5	6	7	8	9	10	11		
Order code selection in psi			526. X X X X X X X X X X X X												
Pressure range ¹⁾	0 ... 2 psi		9	B	2										
	0 ... 3 psi		9	B	4										
	0 ... 5 psi		9	B	6										
	0 ... 10 psi		9	C	0										
Sealing material	FPM	Fluoro elastomer					0	0							
	EPDM	Ethylene propylene					1	0							
	NBR	Butadiene acrylonitrile					2	0							
	MVQ	Silicone polymer					3	0							
Output / power supply	ratiom. 10 ... 90%	5VDC ±10%						7							
Electrical connection	Connector	DIN EN 175301-803-A ²⁾								1					
		DIN EN 175301-803-C (industrial standard 9.4 mm) ²⁾								2					
		M12x1 ²⁾								3					
Pressure connection ¹⁾	Inside thread	G ¼ with O-Ring seal FPM									1	1	1		
		¼ -18 NPT									3	1	1		
		G ¼ sealed at back DIN 3852-E with profile seal FPM									4	1	1		
		G ¼ sealed at front									J	1	2		
		Outside thread	G ½ sealed at front									M	1	1	
			G ½ sealed at back DIN 3852-E with profile seal FPM									H	1	1	
			G ½ sealed at back and manometer with profile seal FPM									8	1	1	
			G ½ sealed at front									9	1		
Material	Stainless steel 1.4404 / AISI 316 L												1		
pressure connection	PVDF outside thread sealed at front for G ¼, G ½												2		
Pressure range variation (optional)	Indicate W and sate range on order (e.g.: W0... + 0.4psi/OUT0.5...4.5V)													W	

			1	2	3	4	5	6	7	8	9	10	11		
Order code selection in MPa			526. X X X X X X X X X X X X												
Pressure range ¹⁾	0 ... 0.01 MPa		9	G	2										
	0 ... 0.016 MPa		9	G	3										
	0 ... 0.02 MPa		9	G	4										
	0 ... 0.025 MPa		9	G	5										
	0 ... 0.03 MPa		9	G	6										
	0 ... 0.04 MPa		9	G	7										
	0 ... 0.06 MPa		9	H	0										
Sealing material	FPM	Fluoro elastomer					0	0							
	EPDM	Ethylene propylene					1	0							
	NBR	Butadiene acrylonitrile					2	0							
	MVQ	Silicone polymer					3	0							
Output / power supply	ratiom. 10 ... 90%	5VDC ±10%						7							
Electrical connection	Connector	DIN EN 175301-803-A ²⁾								1					
		DIN EN 175301-803-C (industrial standard 9.4 mm) ²⁾								2					
		M12x1 ²⁾								3					
Pressure connection ¹⁾	Inside thread	G ¼ with O-ring seal FPM									1	1	1		
		¼ -18 NPT									3	1	1		
		G ¼ sealed at back DIN 3852-E with profile seal FPM									4	1	1		
		G ¼ sealed at front									J	1	2		
		Outside thread	G ½ sealed at front									M	1	1	
			G ½ sealed at back DIN 3852-E with profile seal FPM									H	1	1	
			G ½ sealed at back and manometer with profile seal FPM									8	1	1	
			G ½ sealed at front									9	1		
Material	Stainless steel 1.4404 / AISI 316 L												1		
pressure connection	PVDF outside thread sealed at front for G ¼, G ½												2		
Pressure range variation (optional)	Indicate W and sate range on order (e.g.: W0... + 0.05MPa/OUT0.5...4.5V)													W	

¹⁾ Other pressure ranges and pressure connection on request

²⁾ Delivery without female connector

Accessories

Female connector DIN EN 175301-803-A with seal
 Female connector DIN EN 175301-803-C with seal
 Corner-wire box for connector M12x1
 Calibration certificate

Order number
 103510
 104244
 106975
 104551

Dimensions in mm / Electrical connections

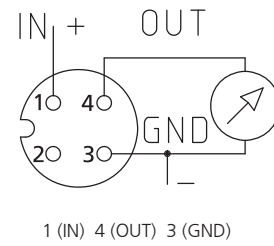
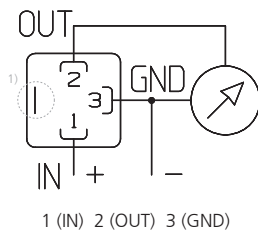
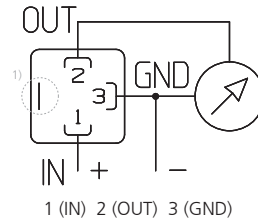
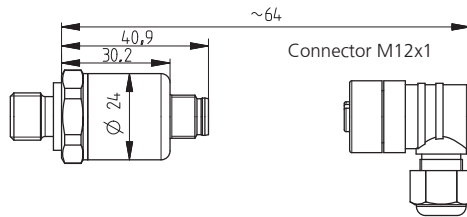
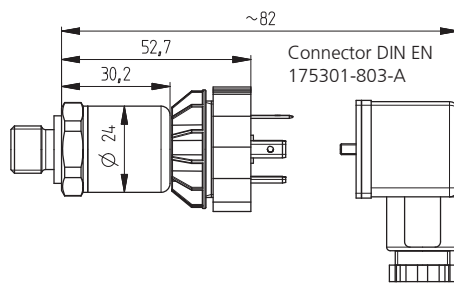
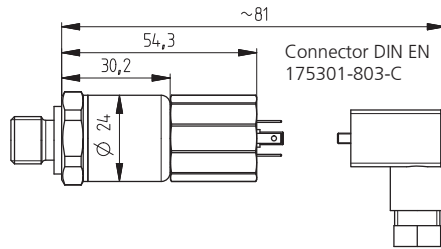
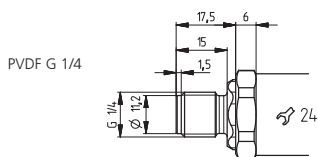
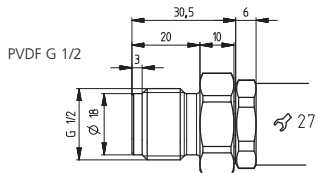
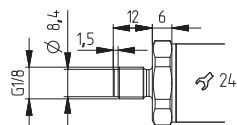
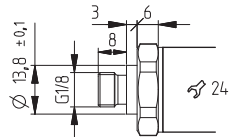
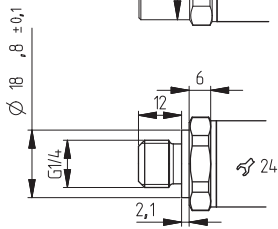
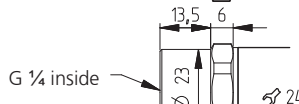
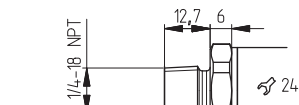
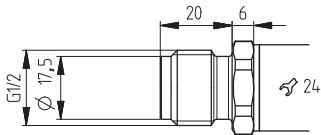
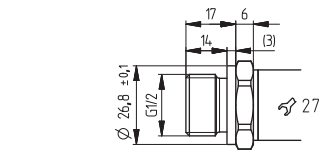

¹⁾ Not connected with transmitter housing

Huba Control AG

Headquarters

Industriestrasse 17
5436 Würenlos
Telefon +41 (0) 56 436 82 00
Telefax +41 (0) 56 436 82 82
info.ch@hubacontrol.com

Huba Control AG

Niederlassung Deutschland

Schlattgrabenstrasse 24
72141 Walddorfhäslach
Telefon +49 (0) 7127 23 93 00
Telefax +49 (0) 7127 23 93 20
info.de@hubacontrol.com

Huba Control SA

Succursale France

Rue Lavoisier
Technopôle Forbach-Sud
57602 Forbach Cedex
Téléphone +33 (0) 387 847 300
Télécopieur +33 (0) 387 847 301
info.fr@hubacontrol.com

Huba Control AG

Vestiging Nederland

Hamseweg 20A
3828 AD Hoogland
Telefoon +31 (0) 33 433 03 66
Telefax +31 (0) 33 433 03 77
info.nl@hubacontrol.com

Huba Control AG

Branch Office United Kingdom

Unit 13 Berkshire House
County Park Business Centre
Shrivenham Road
Swindon Wiltshire SN1 2NR
Phone +44 (0) 1993 776667
Fax +44 (0) 1993 776671
info.uk@hubacontrol.com